

Appliance information

The silo pressure detector is protecting silos and vessels from too high pressure during the pneumatic filling process.

Dimensions

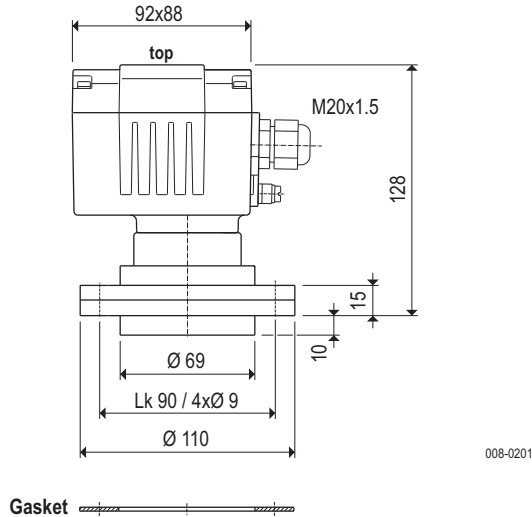

Supplies

Protruding nozzle

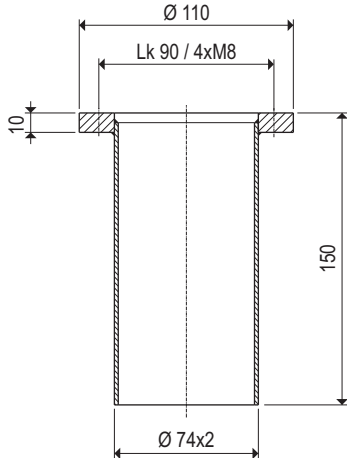

Wiring connection

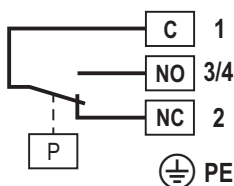

Use

The silo pressure detector is used as limit switch to control the pressure in silos and vessels, being filled by a pneumatic conveyer system. If the pressure is reaching the switching point, the pressure detector will give a signal.

Mode of operation

Using the increasing pressure in the silo or vessel. Increases the pressure to the membrane, the signal switch registers the pressure difference and evaluates it.

Technical data

Materials	Housing A1	Aluminium
	Housing A2	Stainless steel 1.4408 / 316
	Flange F1A	Aluminium
	Flange F1I	Stainless steel 1.4571 / 316 Ti
	Membrane	Stainless steel 1.4301 / 304
	Protruding nozzle	Steel
Bulk goods temperature	T_s	-25 °C ... +80 °C
Ambient temperature	T_a	-20 °C ... +70 °C
Signal-contact	Contact	change-over contact, potentialfree
	max. Switching voltage	U ₀ ≤ 30 V
	max. Braking capacity	I _k ≤ 0.1 A
		intrinsically safe
Switching point	SP	40 mbar = 0.04 bar = 400 mm WS
Overpressure safety		up to 0.5 bar
Cable entry		Gland M20x1.5
Type of protection	IP	IP66 acc. to DIN EN 60529
Weight	A1F1A	1.2 kg
	A1F1I	2.1 kg
	A2F1I	2.9 kg
Maintenance		none
Installation		vertical

ATEX-Option

B5
or
B22



II 1/2D Ex ta/tb IIIC T80 °C
II 2G Ex ib IIC T6
or
II 1D Ex ta IIIC T80 °C
II 1G Ex ia IIC T6

008-AP00

Subject to modification